

止水壁

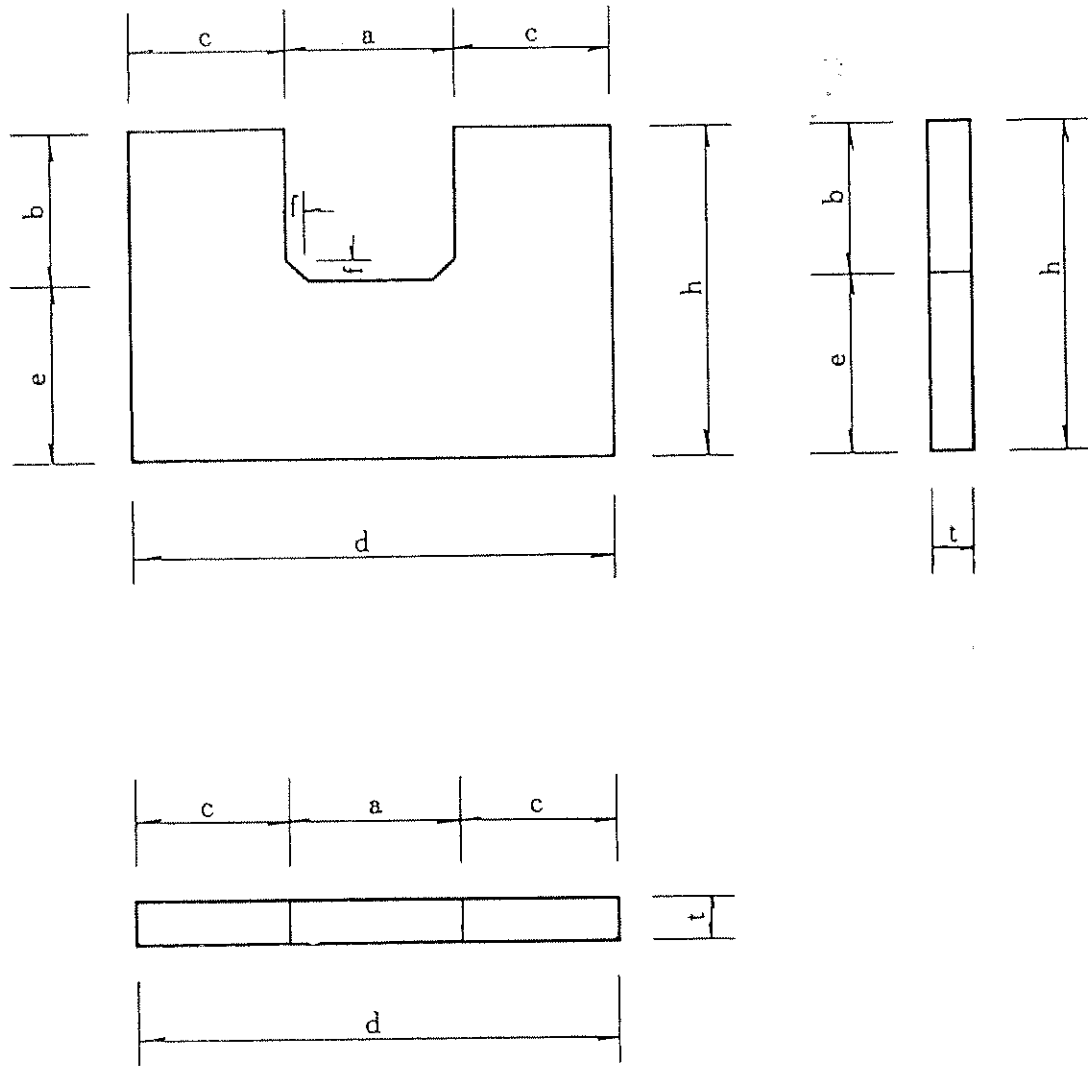

呼び名	寸法 (単位mm)								標準重量 (kg)
	a	b	c	d	e	r	h	t	
300	420	370	290	1000	430	50	800	200	299
450	580	530	410	1400	470	65	1000	200	460
600	760	690	370	1500	510	70	1200	200	600

止水壁(農地開発用)

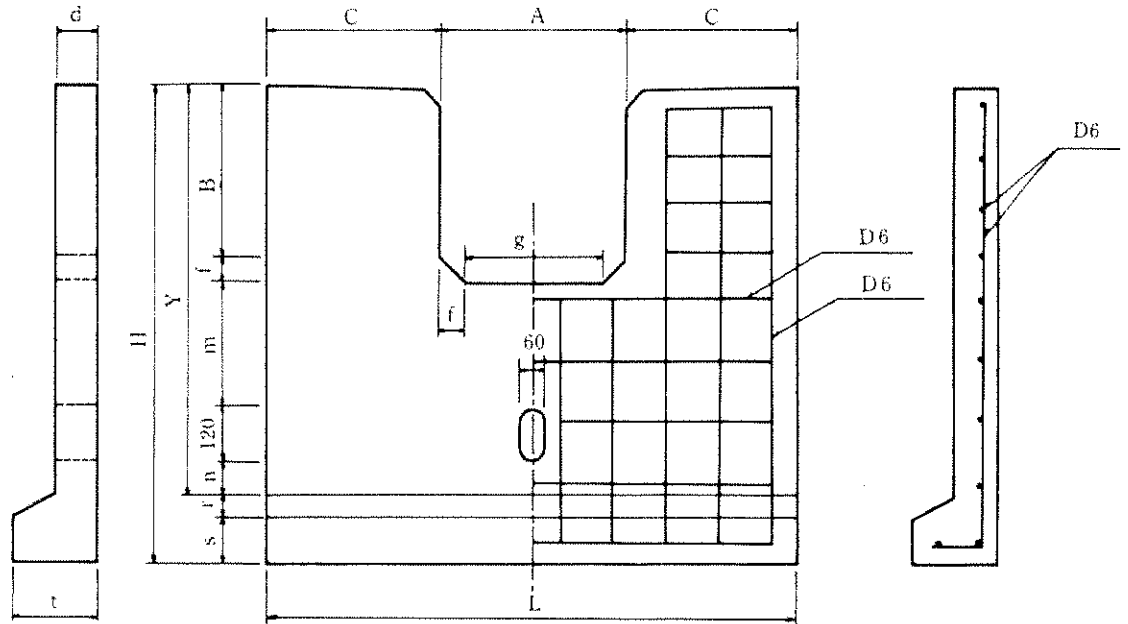

呼び名	寸 法														縦筋 本	横筋 本	重量 kg
	A	B	C	d	f	g	H	L	m	n	r	s	t	Y			
240	350	350	325	100	45	260	965	1,000	280	50	50	100	200	815	12	11	226
300	420	420	390	100	50	320	1,050	1,200	280	60	50	100	200	900	14	12	288
450	580	580	460	120	65	450	1,255	1,500	280	70	60	120	240	1,075	16	14	496
600	760	740	520	150	70	620	1,470	1,800	280	80	75	150	300	1,240	20	16	844

皿型側溝

皿型側溝 I 型 (土現規格)

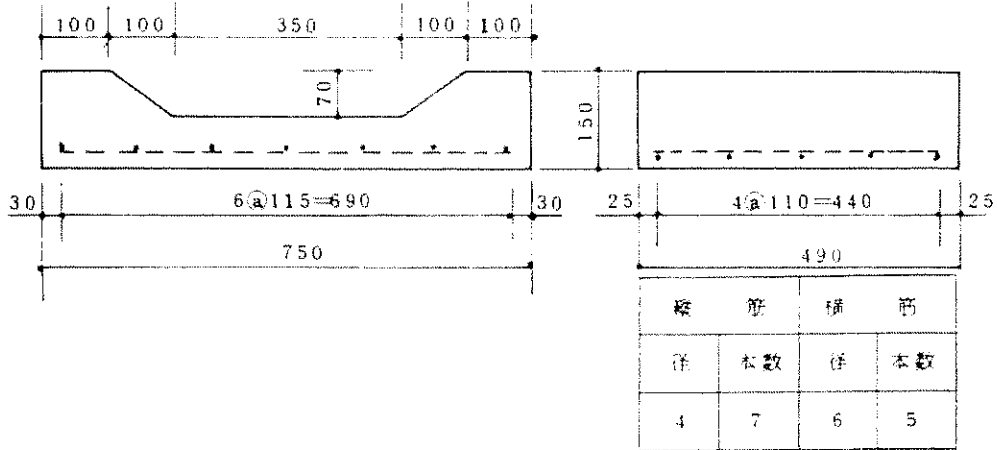

皿型側溝 III 型 (土現規格)

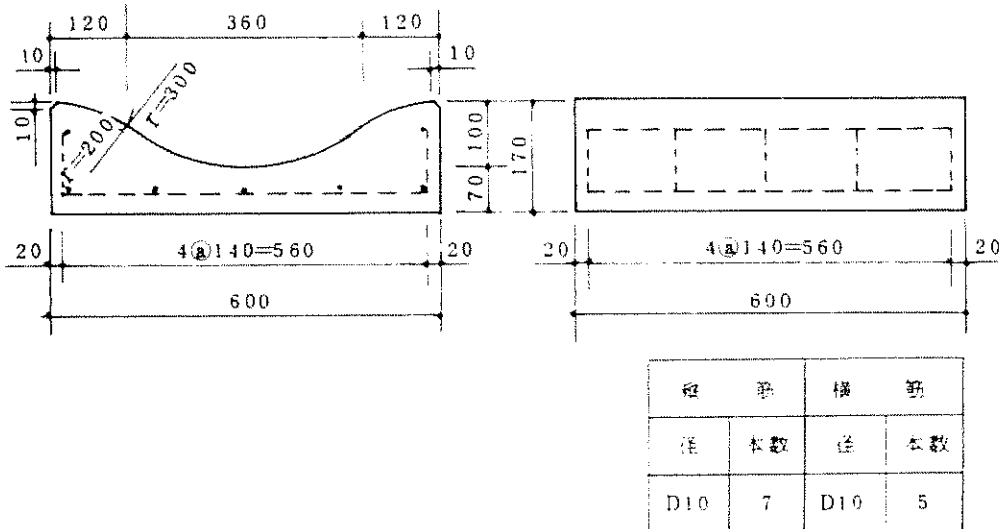

皿型側溝 IV 型 (土現規格)

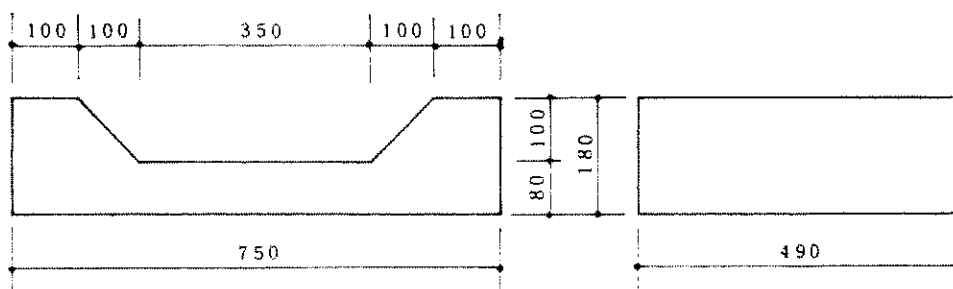

皿型側溝V型（土現規格）

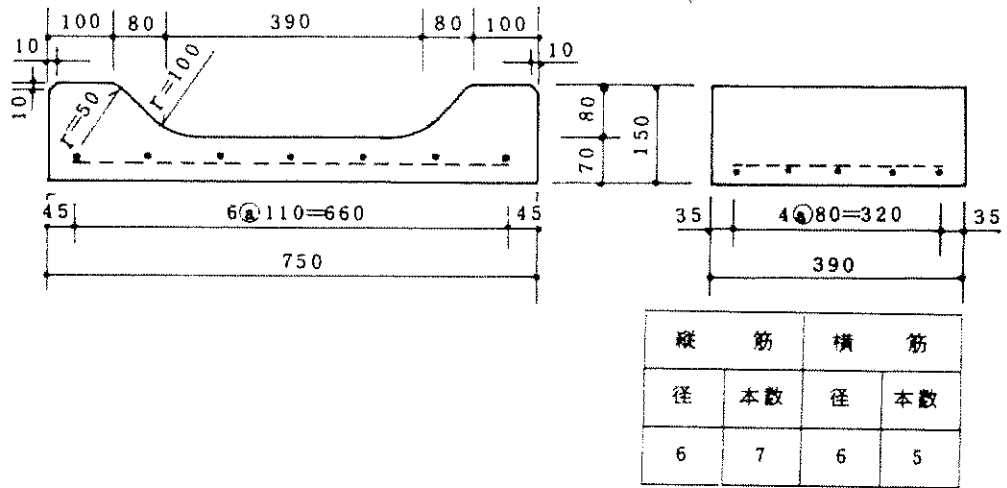

皿型側溝（開建規格）

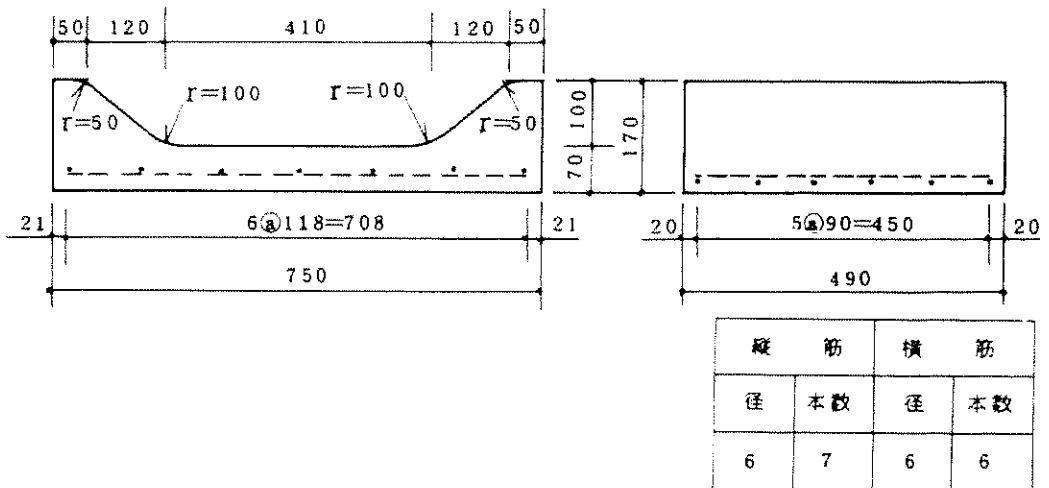

コンクリートL形及び鉄筋コンクリートL形

コンクリートL形 JIS A 5306

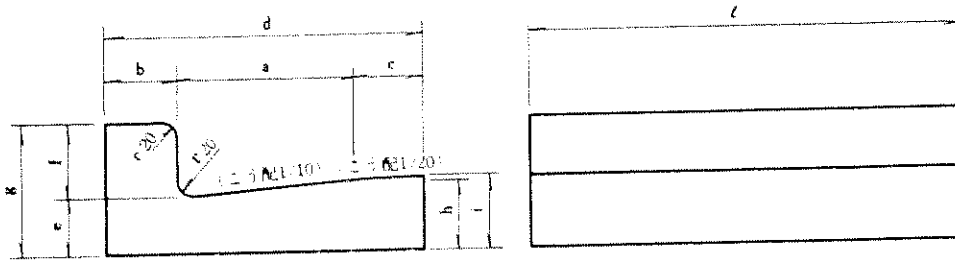

鉄筋コンクリートL形 JISA 5306

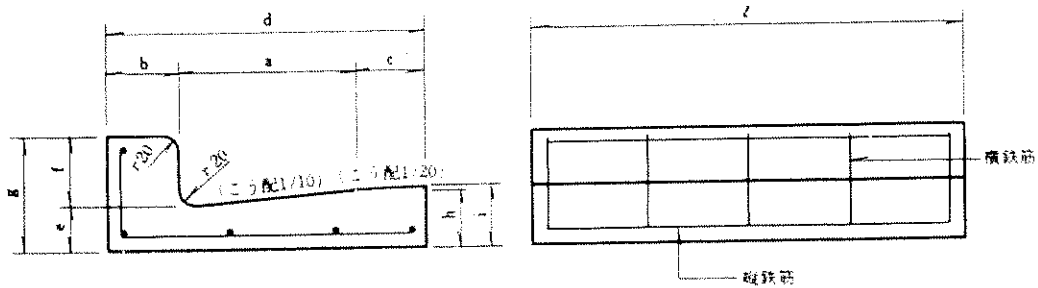

呼び名	寸法(単位mm)										縦鉄筋		横鉄筋		標準重量(kg)	
	a	b	c	d	e	f	g	h	i	ℓ	径	本数	径	本数		
コンクリート L形	250 A	250	100	—	350	75	100	175	100	—	600	—	—	—	—	54
	250 B	250	100	100	450	75	100	175	100	105	600	—	—	—	—	68
鉄筋 コンクリート L形	250 A	250	100	—	350	55	100	155	80	—	600	4.0	4	4.0	5	46
	250 B	250	100	100	450	55	100	155	80	85	600	4.0	5	4.0	5	58
	300	300	100	100	500	55	100	155	85	90	600	4.0	5	4.0	6	65
	350	350	100	100	550	55	100	155	90	95	600	4.0	5	6.0	5	72

開発 I 型縁石

N-1 標準縁石

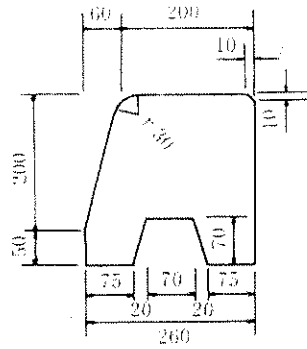

変形 A

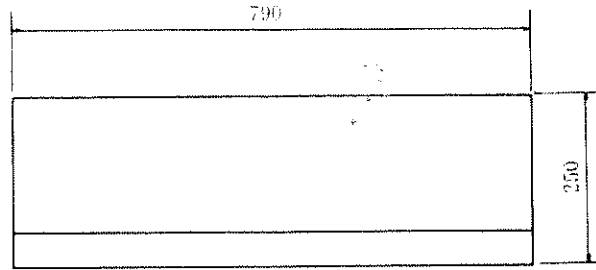

重量 = 99kg

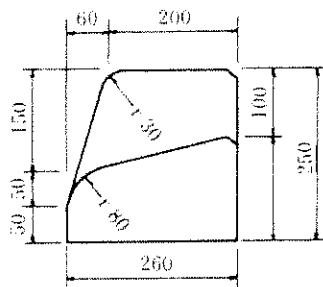

変形 B

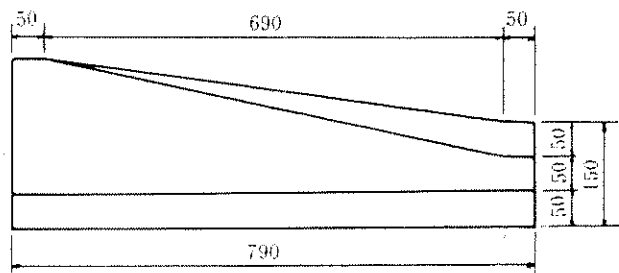

重量 = 77kg

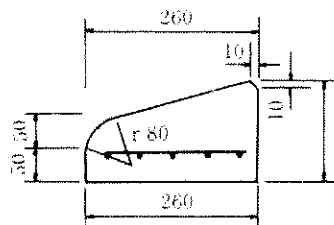

特殊変形 A

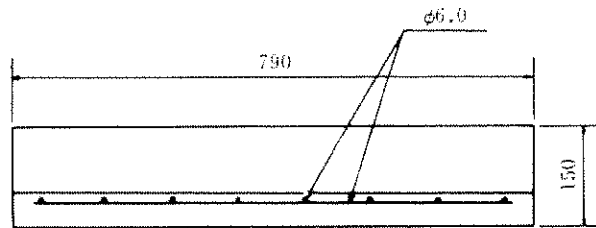

重量 = 59kg

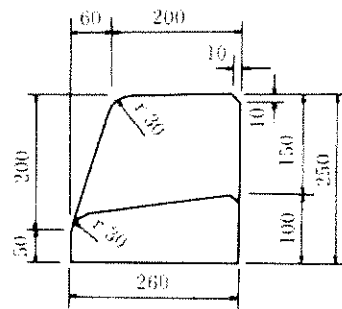

特殊変形 B

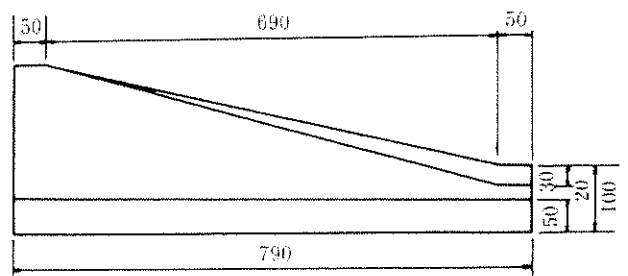

重量 = 72kg

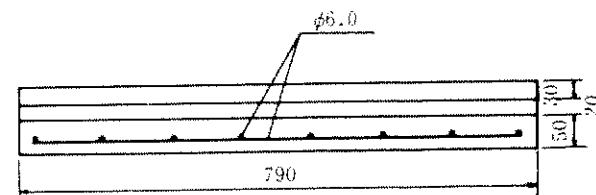
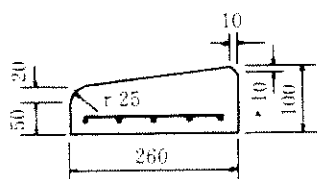

重量 = 41kg

特殊变形 A 1

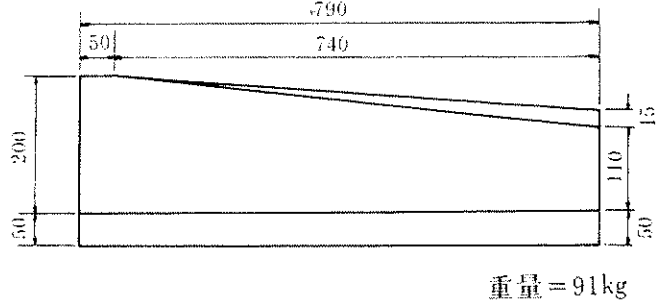
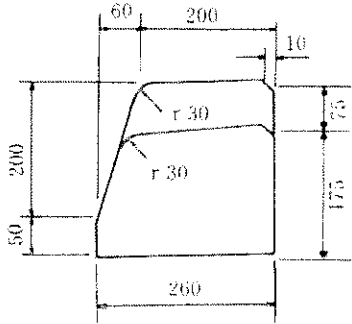

特殊变形 A 2

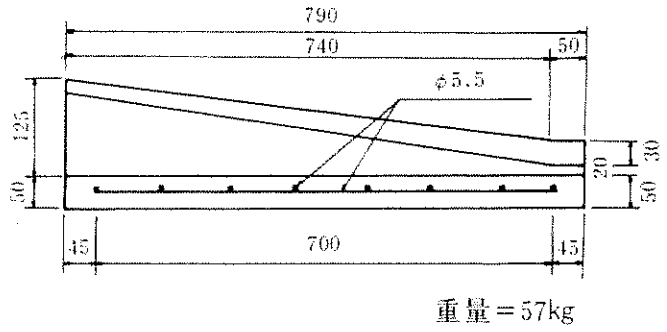
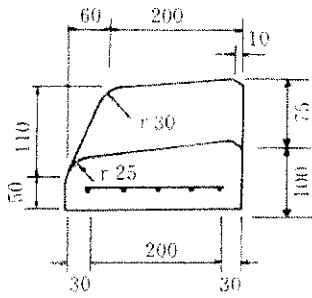

施工图

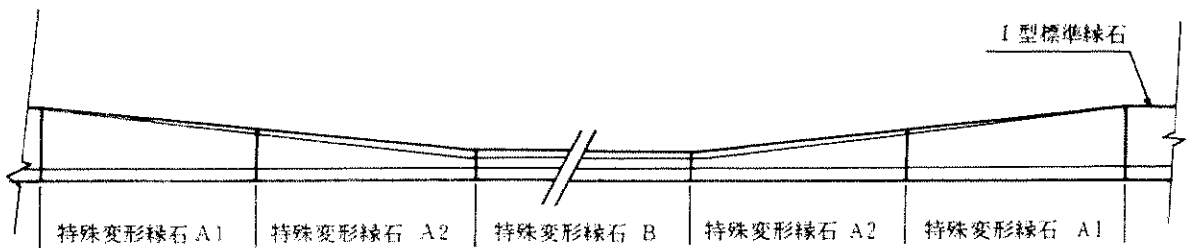

開発Ⅱ型縁石

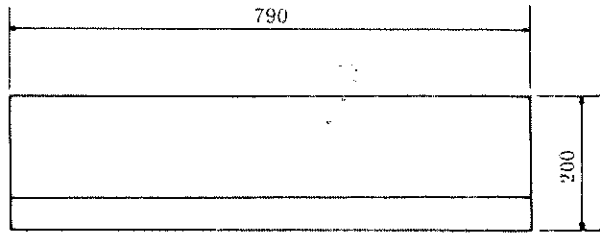
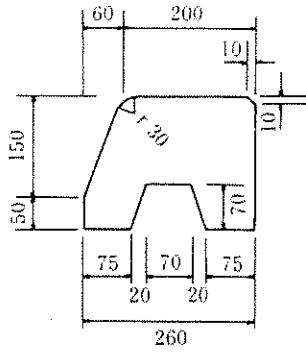

重量 = 77kg

変形 A

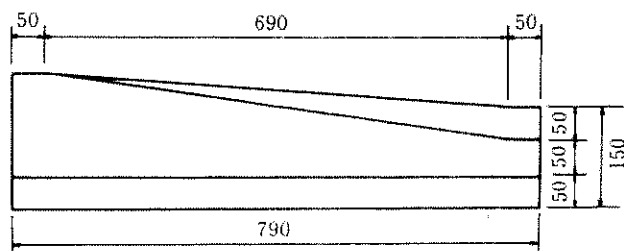
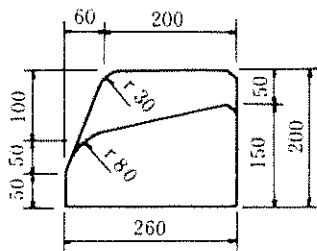

重量 = 72kg

変形 B

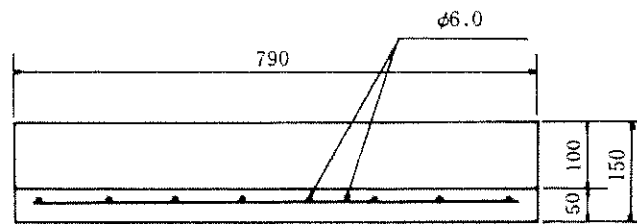
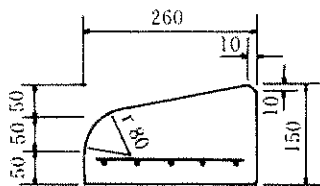

重量 = 59kg

特殊変形 A

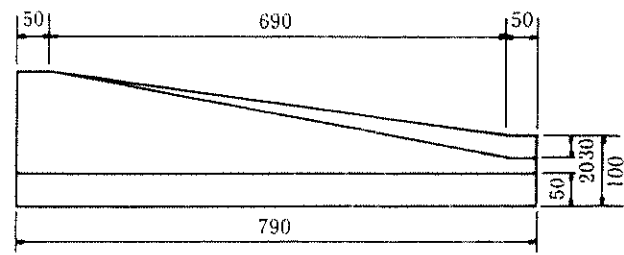
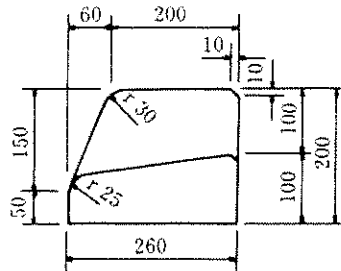

重量 = 64kg

特殊変形 B

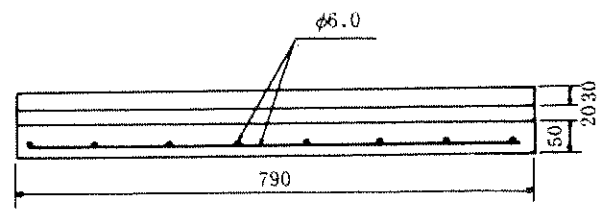
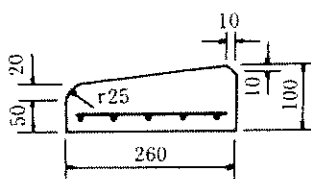

重量 = 41kg

特殊变形 A 1

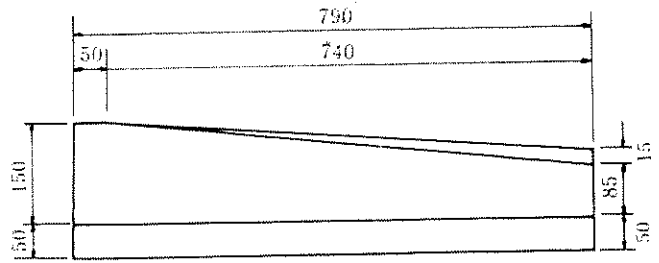
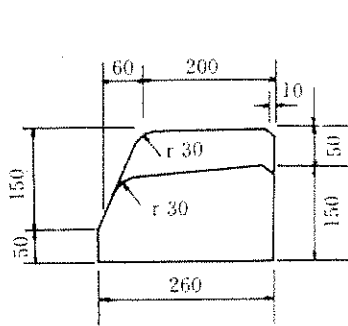

重量 = 74kg

特殊变形 A 2

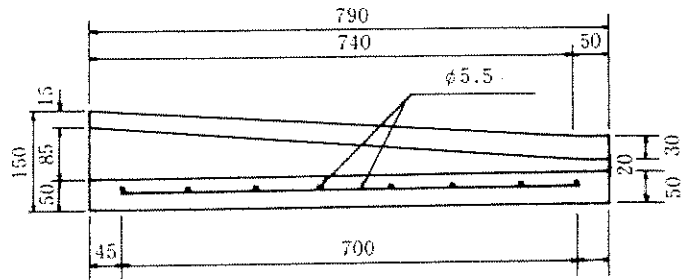
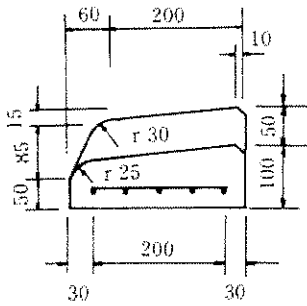

重量 = 52kg

施工图

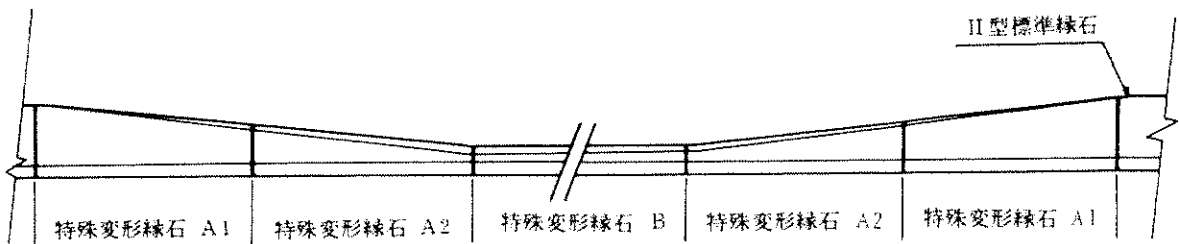

開発型導水縁石

N-3 標準縁石 150×190×150×790mm

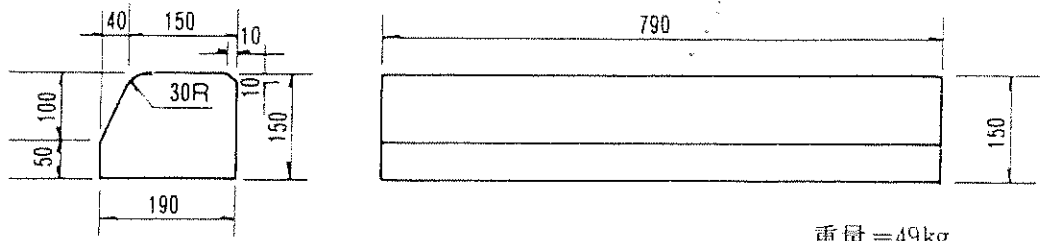

重量 = 49kg

変形 A 150×190×150/100×790mm

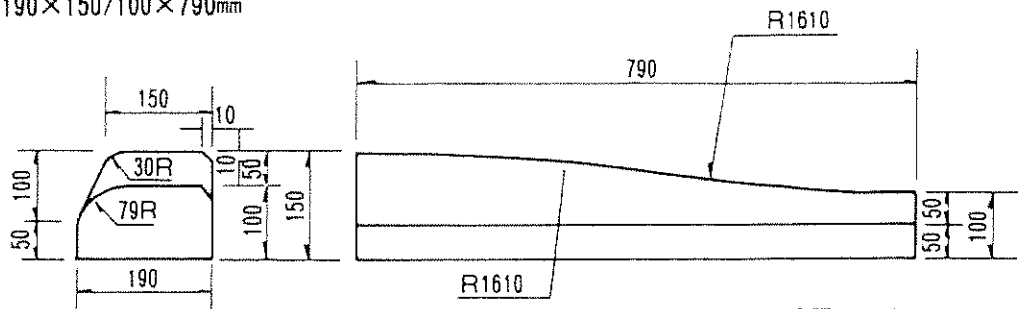

重量 = 41kg

変形 B 190×100×790mm

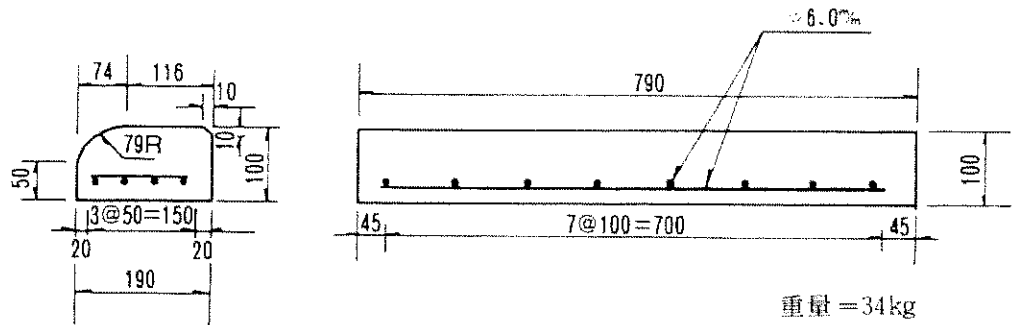

重量 = 34kg

特殊変形 A

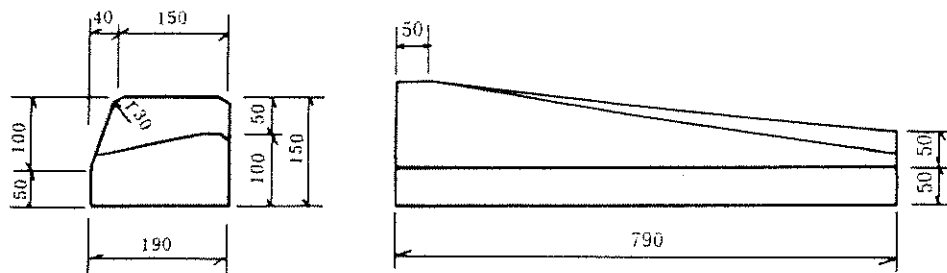

重量 = 39kg

特殊変形 B

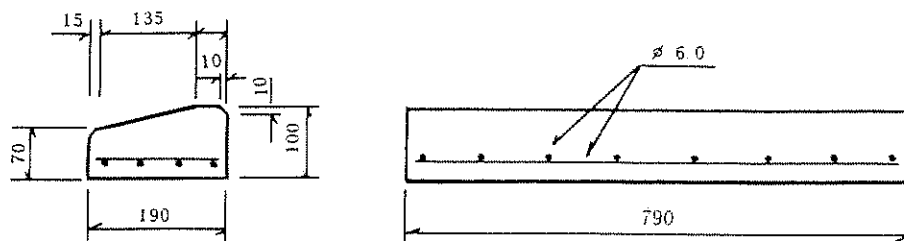

重量 = 30kg

土現型縁石

ND-2 標準縁石

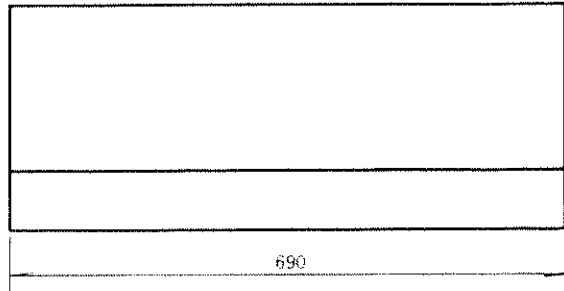
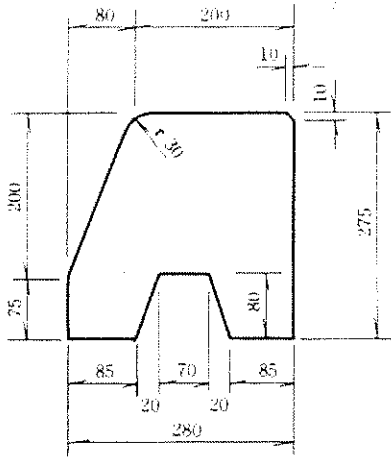

W = 101kg

A 変形

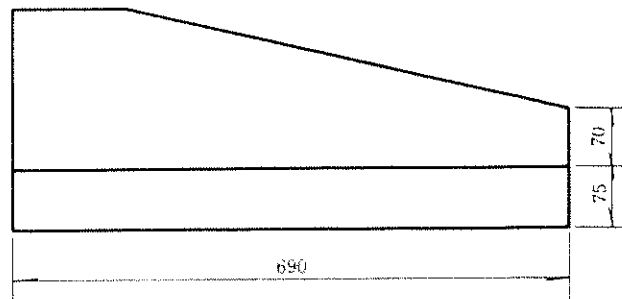
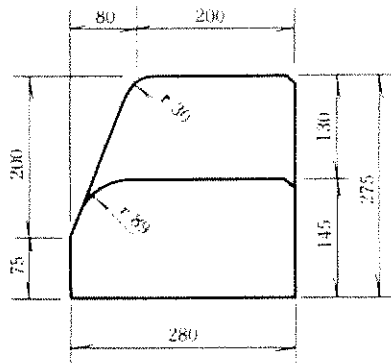

W = 91kg

B 変形

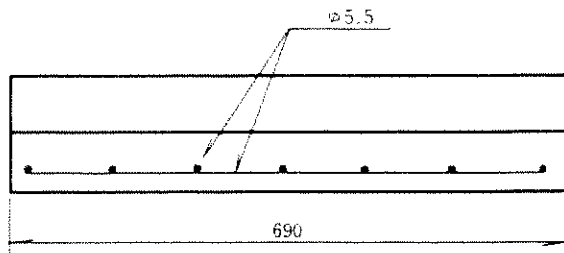
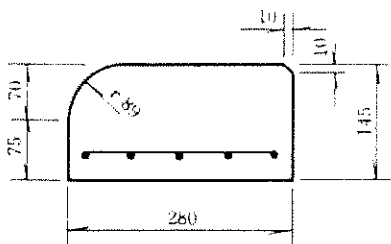

W = 65kg

特殊A 変形

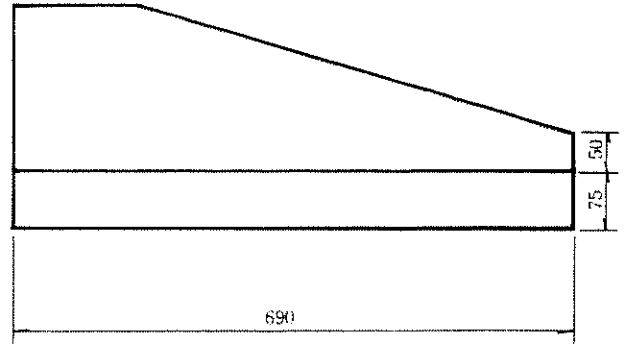
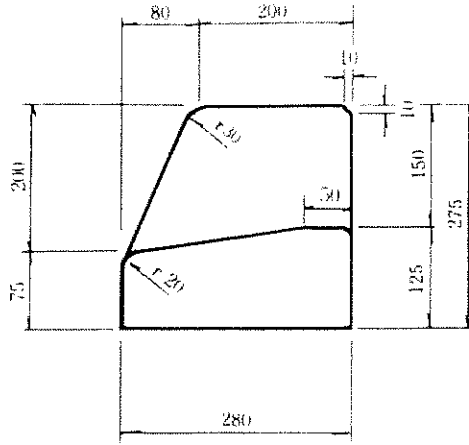

W = 96kg

特殊B 変形

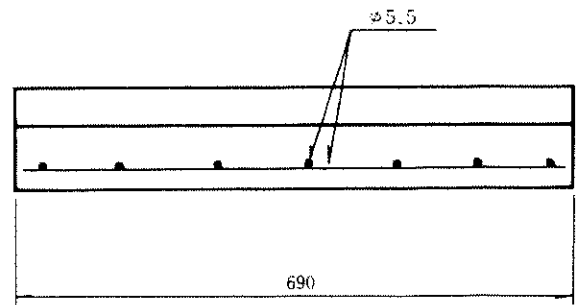
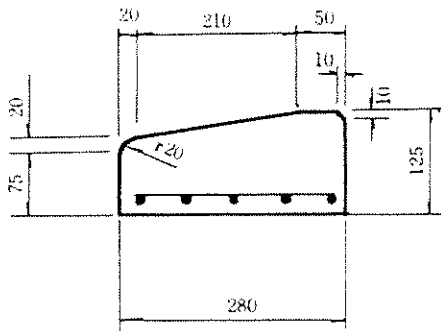

W = 51kg

特殊变形 A1

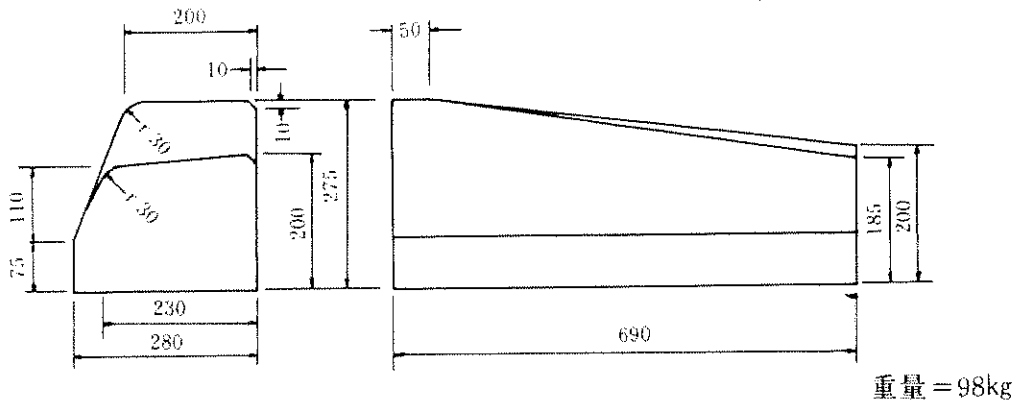

特殊变形 A2

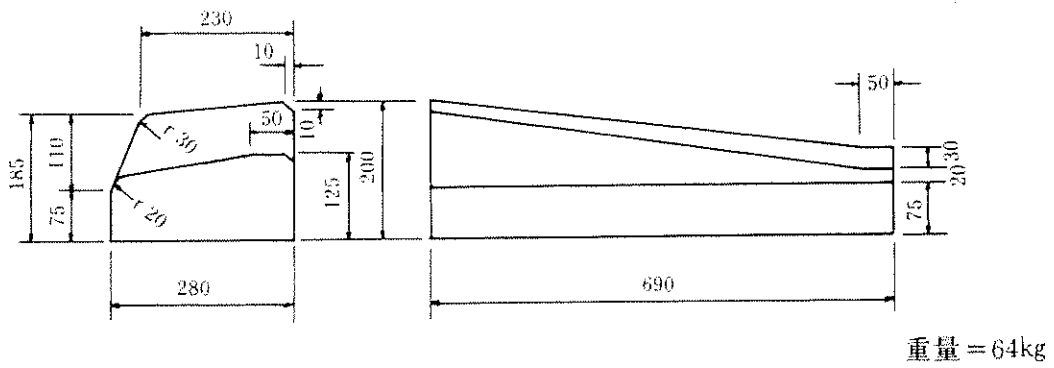

施工图

左

右

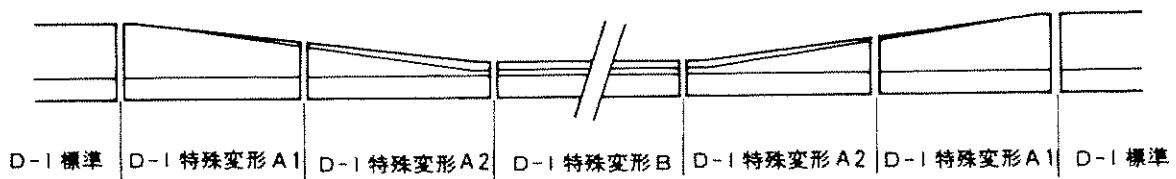

土現型導水縁石

ND-4 標準縁石

W=43kg

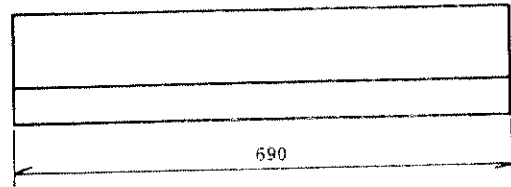
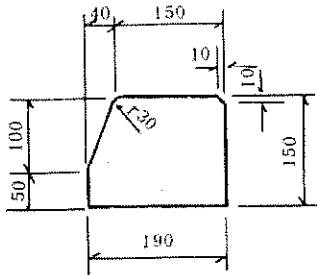

ND-4A変形

W=34kg

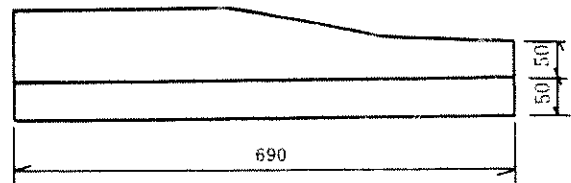
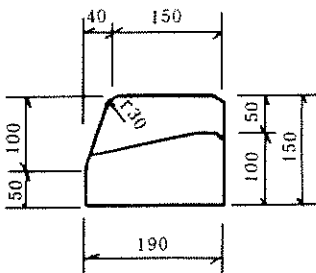

ND-4B変形

W=28kg

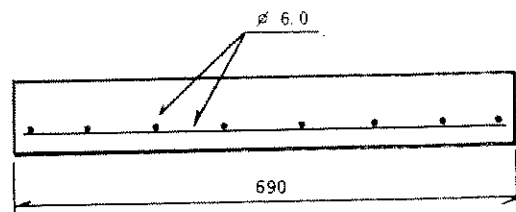
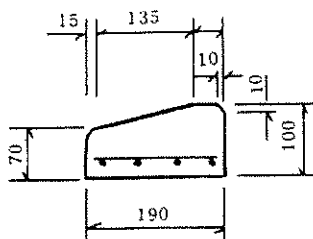

土現型郊外地導水縁石

ND-5 標準縁石

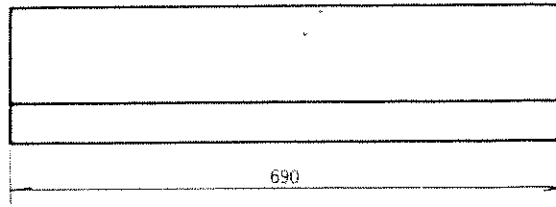
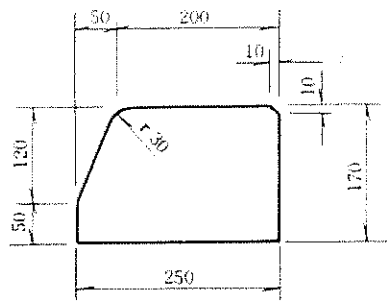

W=62kg

A 変形

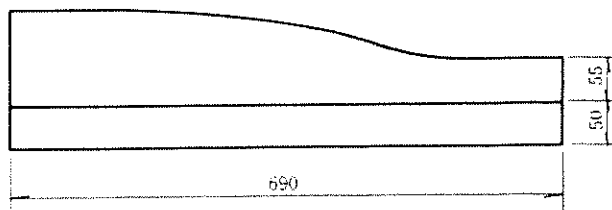
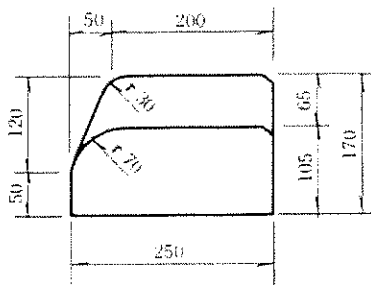

W=55kg

B 変形

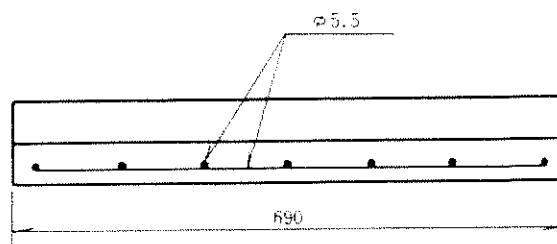
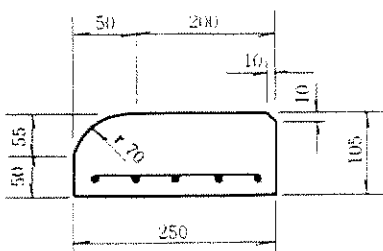

W=41kg

舗装止縁石

車道舗装止縁石

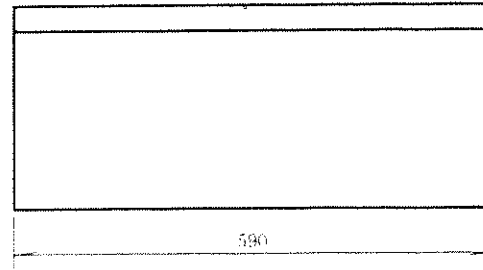
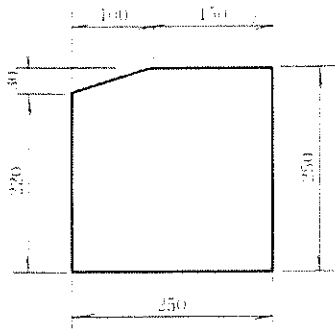

W=84kg

N-6 歩道舗装止縁石

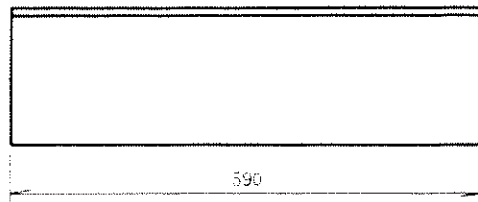
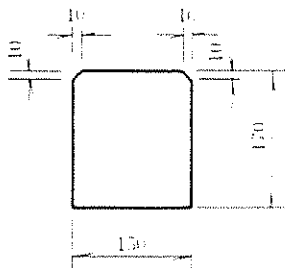

W=35kg

コンクリート境界ブロック

歩車道境界ブロック

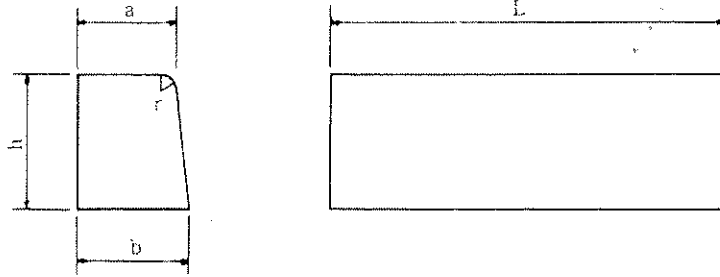

地先境界ブロック

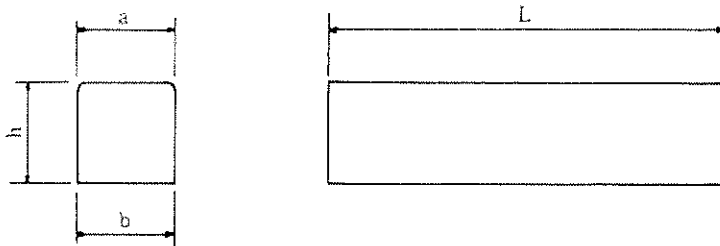

呼 び 名		寸 法					破 壊 荷 重	重 量
		mm						
		a	b	h	r	L	kg	kg
歩 車 道 境 界 ブ ロ ッ ク	A	150	170	200	20	600	2,300	44
	B	180	205	250	30		4,000	66
	C	180	210	300	30		6,000	80
地 先 境 界 ブ ロ ッ ク	A	120	120	120	—	600	650	19
	B	150	150	120			800	24
	C	150	150	150			1,300	31

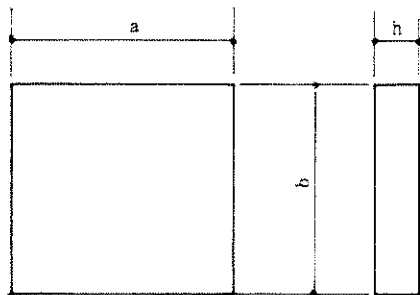

(単位mm)

呼 び 名		a	b	h
歩 道 用 コ ン ク リ ー ト 平 板	300	300	300	60
	330	330	330	60
寸 法 許 容 差		+ 2		

仕切縁石

仕切縁石A

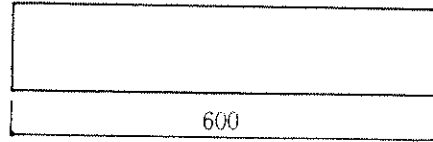
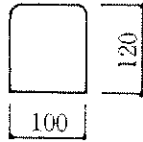

W = 17kg

仕切縁石B

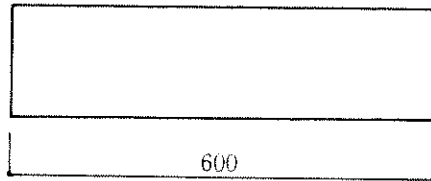
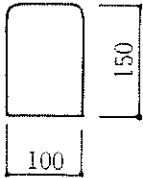

W = 21kg

仕切縁石C

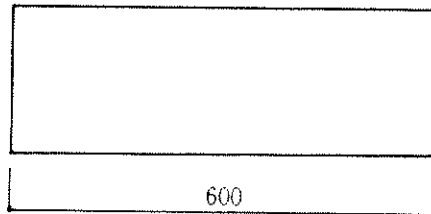
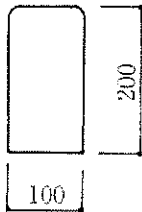

W = 28kg

仕切縁石D

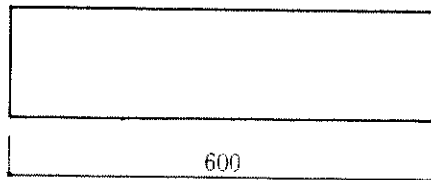
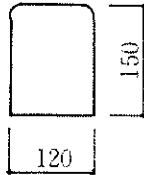

W = 24kg